



 **FILE COPY**

Illinois Department of Transportation

Office of Highways Project Implementation / Region 2 / District 2
819 Depot Avenue / Dixon, Illinois 61021-3500

TARP
Lee County
Section 22-00353-00-RS
Chicago Rd
Joint Funding Agreement

March 8, 2024

Mr. David Anderson, P.E.
Lee County Engineer
P.O. Box 193
Amboy, Illinois 61310

Dear Mr. Anderson:

Please find attached five (5) copies of the Local Public Agency Joint Funding Agreement (BLR 05310C) for the subject project. The State commitment will not exceed \$145,800.00 in Truck Access Route Program funds. A resolution to pay costs above the State funds must be passed to cover Lee Counties share of the costs.

Please return four (4) copies of the agreement with original signatures on each to this office, ensuring:

1. Page 5 is signed and dated with correct tax identification and DUNS numbers provided.
2. Four original copies of the resolution for local appropriations of funds are included with original signatures in effect on or prior to the execution date of the agreement.
3. Resolution establishing a class II truck route is included.

If you have questions or need any additional information regarding the above, please contact Shawn Orgiesen, P.E., at (815) 284-5381.

Sincerely,

Trisha Thompson, P.E.
Region Two Engineer



By: Shawn Orgiesen, P.E.
District Local Roads Engineer

Enclosure

SO 03-08-24-1



Joint Funding Agreement for Construction Work

LOCAL PUBLIC AGENCY

Local Public Agency	County	Section Number	
Lee County	Lee	22-00353-00-RS	
Fund Type	ITEP, SRTS, HSIP Number(s)	MPO Name	MPO TIP Number
TARP	N/A	N/A	N/A

Construction

State Job Number	Project Number
C-92-047-24	

☐ State-Let Construction ☒ Locally Let Construction ☐ Construction Engineering ☐ Utilities ☐ Railroad Work

This Agreement is made and entered into between the above local public agency, hereinafter referred to as the "LPA" and the State of Illinois, acting by and through its Department of Transportation, hereinafter referred to as "STATE". The STATE and LPA jointly propose to improve the designated location as described below. The improvement shall be consulted in accordance with plans prepared by, or on behalf of the LPA and approved by the STATE using the STATE's policies and procedures approved and/or required by the Federal Highway Administration, hereinafter referred to as "FHWA".

LOCATION

Local Street/Road Name	Key Route	Length	From	To
Chicago Road	FAS 0177	1.60 miles	19.18	20.78

Location Termini
Village of Paw Paw limits to DeKalb County Line

Current Jurisdiction	Existing Structure Number(s)	Add Location
Lee County		Remove

PROJECT DESCRIPTION

The project consists of the placement of two lifts of HMA, longitudinal joint sealant, aggregate shoulders, and other ancillary work.

LOCAL PUBLIC AGENCY APPROPRIATION - REQUIRED FOR STATE LET CONTRACTS

By execution of this Agreement the LPA attests that sufficient moneys have been appropriated or reserved by resolution or ordinance to fund the LPA share of project costs. A copy of the authorizing resolution or ordinance is attached as an addendum.

METHOD OF FINANCING - (State-Let Contract Work Only)

Check One

☐ METHOD A - Lump Sum (80% of LPA Obligation _____)

Lump Sum Payment - Upon award of the contract for this improvement, the LPA will pay the STATE within thirty (30) calendar days of billing, in lump sum, an amount equal to 80% of the LPA's estimated obligation incurred under this agreement. The LPA will pay to the STATE the remainder of the LPA's obligation (including any nonparticipating costs) in a lump sum within thirty (30) calendar days of billing in a lump sum, upon completion of the project based on final costs.

☐ METHOD B - _____ Monthly Payments of _____ due by the _____ of each successive month.

Monthly Payments - Upon award of the contract for this improvement, the LPA will pay to the STATE a specified amount each month for an estimated period of months, or until 80% of the LPA's estimated obligation under the provisions of the agreement has been paid. The LPA will pay to the STATE the remainder of the LPA's obligation (including any nonparticipating costs) in a lump sum, upon completion of the project based upon final costs.

☐ METHOD C - LPA's Share _____ divided by estimated total cost multiplied by actual progress payment.

Progress Payments - Upon receipt of the contractor's first and subsequent progressive bills for this improvement, the LPA will pay to the STATE within thirty (30) calendar days of receipt, an amount equal to the LPA's share of the construction cost divided by the estimated total cost multiplied by the actual payment (appropriately adjust for nonparticipating costs) made to the contractor until the entire obligation incurred under this agreement has been paid.

Failure to remit the payment(s) in a timely manner as required under Methods A, B, or C shall allow the **STATE** to internally offset, reduce, or deduct the arrearage from any payment or reimbursement due or about to become due and payable from the **STATE** to the **LPA** on this or any other contract. The **STATE** at its sole option, upon notice to the **LPA**, may place the debit into the Illinois Comptroller's Offset System (15 ILCS 405/10.05) or take such other and further action as may be required to recover the debt.

THE LPA AGREES:

1. To acquire in its name, or in the name of the **STATE** if on the **STATE** highway system, all right-of-way necessary for this project in accordance with the requirements of Titles II and III of the Uniform Relocation Assistance and Real Property Acquisition Policies Act of 1970, and established State policies and procedures. Prior to advertising for bids, the **LPA** shall certify to the **STATE** that all requirements of Titles II and III of said Uniform Act have been satisfied. The disposition of encroachments, if any, will be cooperatively determined by representatives of the **LPA**, the **STATE**, and the **FHWA** if required.
2. To provide for all utility adjustments and to regulate the use of the right-of-way of this improvement by utilities, public and private, in accordance with the current Utility Accommodation Policy for Local Public Agency Highway and Street Systems.
3. To provide for surveys and the preparation of plans for the proposed improvement and engineering supervision during construction of the proposed improvement.
4. To retain jurisdiction of the completed improvement unless specified otherwise by addendum (addendum should be accompanied by a location map). If the improvement location is currently under road district jurisdiction, a jurisdictional addendum is required.
5. To maintain or cause to be maintained the completed improvement (or that portion within its jurisdiction as established by addendum referred to in item 4 above) in a manner satisfactory to the **STATE** and the **FHWA**.
6. To comply with all applicable Executive Orders and Federal Highway Acts pursuant to the Equal Employment Opportunity and Nondiscrimination Regulations required by the U.S. Department of Transportation.
7. To maintain for a minimum of 3 years after final project close out by the **STATE**, adequate books, records and supporting documents to verify the amounts, recipients and uses of all disbursements of funds passing in conjunction with the contract. The contract and all books, records, and supporting documents related to the contract shall be available for review and audit by the Auditor General and the **STATE**. The **LPA** agrees to cooperate fully with any audit conducted by the Auditor General, the **STATE**, and to provide full access to all relevant materials. Failure to maintain the books, records, and supporting documents required by this section shall establish presumption in favor of the **STATE** for recovery of any funds paid by the **STATE** under the contract for which adequate books, records and supporting documentation are not available to support their purported disbursement.
8. To provide if required, for the improvement of any railroad-highway grade crossing and rail crossing protection within the limits of the proposed improvement.
9. To comply with Federal requirements or possibly lose (partial or total) Federal participation as determined by the **FHWA**.
10. To provide or cause to be provided all of the initial funding, equipment, labor, material, and services necessary to complete locally administered portions of the project.
11. (Railroad Related Work) The **LPA** is responsible for the payment of the railroad related expenses in accordance with the **LPA**/railroad agreement prior to requesting reimbursement from the **STATE**. Requests for reimbursement should be sent to the appropriate IDOT District Bureau of Local Roads and Streets Office. Engineer's Payment Estimates shall be in accordance with the Division of Cost.
12. Certifies to the best of its knowledge and belief that its officials:
 - a. are not presently debarred, suspended, proposed for debarment, declared ineligible or voluntarily excluded from covered transactions by any Federal department or agency;
 - b. have not within a three-year period preceding this agreement been convicted of or had a civil judgment rendered against them for commission of fraud or a criminal offense in connection with obtaining, attempting to obtain, or performing a public (Federal, State or local) transaction or contract under a public transaction; violation of Federal or State anti-trust statutes or commission of embezzlement, theft, forgery, bribery, falsification or destruction of records, making false statements receiving stolen property;
 - c. are not presently indicted for or otherwise criminally or civilly charged by a governmental entity (Federal, State, Local) with commission of any of the offenses enumerated in item (b) of this certification; and
 - d. have not within a three-year period preceding the agreement had one or more public transactions (Federal, State, Local) terminated for cause or default.
13. To include the certifications, listed in item 12 above, and all other certifications required by State statutes, in every contract, including procurement of materials and leases of equipment.
14. That execution of this agreement constitutes the **LPA's** concurrence in the award of the construction contract to the responsible low bidder as determined by the **STATE**
15. That for agreements exceeding \$100,000 in federal funds, execution of this agreement constitutes the **LPA's** certification that:
 - a. No federal appropriated funds have been paid or will be paid, by or on behalf of the undersigned, to any person for influencing or attempting to influence an officer or employee of any agency, a member of congress, an officer or employee of congress, or any employee of a member of congress in connection with the awarding of any federal contract, the making of any cooperative agreement, and the extension, continuation, renewal, amendment or

- modification of any Federal contract, grant, loan or cooperative agreement.
- b. If any funds other than federal appropriated funds have been paid or will be paid to any person for influencing or attempting to influence an officer or employee of any agency, a member of congress, an officer or employee of congress or an employee of a member of congress in connection with this federal contract, grant, loan, or cooperative agreement, the undersigned shall complete and submit standard form - LLL, "Disclosure Form to Report Lobbying", in accordance with its instructions.
- c. The LPA shall require that the language of this certification be included in the award documents for all subawards (including subcontracts, subgrants and contracts under grants, loans, and cooperative agreements), and that all subrecipients shall certify and disclose accordingly

16. To regulate parking and traffic in accordance with the approved project report.

17. To regulate encroachments on public rights-of-way in accordance with current Illinois Compiled Statutes.

18. To regulate the discharge of sanitary sewage into any storm water drainage system constructed with this improvement in accordance with the current Illinois Compiled Statutes.

THE STATE AGREES:

1. To provide such guidance, assistance, and supervision to monitor and perform audits to the extent necessary to assure validity of the LPA's certification of compliance with Title II and III Requirements.
2. To receive bids for construction of the proposed improvement when the plans have been approved by the **STATE** (and **FHWA**, if required) and to award a contract for construction of the proposed improvement after receipt of a satisfactory bid.
3. To provide all initial funding and payments to the contractor for construction work let by the **STATE**. The LPA will be invoiced for their share of contract costs per the method of payment selected under Method of Financing based on the Division of Costs shown on Addendum 2.
4. For agreements with federal and/or state funds in construction engineering, utility work and/or railroad work:
 - a. To reimburse the LPA for federal and/or state share on the basis of periodic billings, provided said billings contain sufficient cost information and show evidence of payments by the LPA;
 - b. To provide independent assurance sampling and furnish off-site material inspection and testing at sources normally visited by **STATE** inspectors for steel, cement, aggregate, structural steel, and other materials customarily tested by the **STATE**.

IT IS MUTUALLY AGREED:

1. Construction of the project will utilize domestic steel as required by Section 106.01 of the current edition of the Standard Specifications for Road and Bridge Construction and federal Buy America provisions
2. That this Agreement and the covenants contained herein shall become null and void in the event that the **FHWA** does not approve the proposed improvement for Federal-aid participation within one (1) year of the date of execution of this agreement.
3. This agreement shall be binding upon the parties, their successors, and assigns.
4. For contracts awarded by the LPA, the LPA shall not discriminate on the basis of race, color, national origin or sex in the award and performance of any USDOT - assisted contract or in the administration of its DBE program or the requirements of 49 CFR part 26. The LPA shall take all necessary and reasonable steps under 49 CFR part 26 to ensure nondiscrimination in the award and administration of USDOT - assisted contracts. The LPA's DBE program, as required by 49 CFR part 26 and as approved by USDOT, is incorporated by reference in this agreement. Upon notification to the recipient of its failure to carry out its approved program, the **STATE** may impose sanctions as provided for under part 26 and may, in appropriate cases, refer the matter for enforcement under 18 U.S.C. 1001 and/or the Program Fraud Civil Remedies Act of 1986 (31 U.S.C. 3801 et seq.). In the absence of a USDOT - approved LPA DBE Program or on **state** awarded contracts, this agreement shall be administered under the provisions of the **STATE'S** USDOT approved Disadvantaged Business Enterprise Program.
5. In cases where the **STATE** is reimbursing the LPA, obligation of the **STATE** shall cease immediately without penalty or further payment being required if, in any fiscal year, the Illinois General Assembly or applicable federal funding source fails to appropriate or otherwise make available funds for the work contemplated herein.
6. All projects for the construction of fixed works which are financed in whole or in part with funds provided by this agreement and/or amendment shall be subject to the Prevailing Wage Act (820 ILCS 130/0.01 et seq.) unless the provisions of the act exempt its application.

FISCAL RESPONSIBILITIES:

1. **Reimbursement Requests:** For reimbursement requests the LPA will submit supporting documentation with each invoice. Supporting documentation is defined as verification of payment, certified time sheets or summaries, vendor invoices, vendor receipts, cost plus fix fee invoice, progress report, personnel and direct cost summaries, and other documentation supporting the requested reimbursement amount (Form BLR 05621 should be used for consultant invoicing purposes). LPA invoice requests to the **STATE** will be submitted with sequential invoice numbers by project.
2. **Financial Integrity Review and Evaluation (FIRE) program:** LPA's and the **STATE** must justify continued federal funding on inactive projects. 23 CFR 630.106(a)(5) defines an inactive project as a project which no expenditures have been charged against Federal funds for the past twelve (12) months. To keep projects active, invoicing must occur a minimum of one time within any given twelve (12) month period. However, to ensure adequate processing time, the first invoice shall be submitted to

the **STATE** within six (6) months of the federal authorization date. Subsequent invoices will be submitted in intervals not to exceed six (6) months.

3. **Final Invoice:** The LPA will submit to the **STATE** a complete and detailed final invoice with applicable supporting documentation of all incurred costs, less previous payments, no later than twelve (12) months from the date of completion of work or from the date of the previous invoice, whichever occurs first. If a final invoice is not received within this time frame, the most recent invoice may be considered the final invoice and the obligation of the funds closed. Form BLR 05613 (Engineering Payment Record) is required to be submitted with the final invoice for engineering projects.
4. **Project Closeout:** The LPA shall provide the final report to the appropriate **STATE** district office within twelve (12) months of the physical completion date of the project so that the report may be audited and approved for payment. If the deadline cannot be met, a written explanation must be provided to the district prior to the end of the twelve (12) months documenting the reason and the new anticipated date of completion. If the extended deadline is not met, this process must be repeated until the project is closed. Failure to follow this process may result in the immediate close-out of the project and loss of further funding.
5. **Project End Date:** The period of performance (end date) for state and federal obligation purposes is five (5) years for projects under \$1,000,000 or seven (7) years for projects over \$1,000,000 from the execution date of the agreement.

Requests for time extensions and joint agreement amendments must be received and approved prior to expiration of the project end date. Failure to extend the end date may result in the immediate close-out of the project and loss of further funding.
6. **Single Audit Requirements:** If the LPA expends \$750,000 or more a year in federal financial assistance, they shall have an audit made in accordance with 2 CFR 200. LPA's expending less than \$750,000 a year shall be exempt from compliance. A copy of the audit report must be submitted to the **STATE** (IDOT's Office of Internal Audit, Room 201, 2300 South Dirksen Parkway, Springfield, Illinois, 62764) within 30 days after the completion of the audit, but no later than one year after the end of the LPA's fiscal year. The ALN number for all highway planning and construction activities is 20.205. Federal funds utilized for construction activities on projects let and awarded by the **STATE** (federal amounts shown as "Participating Construction" on Addendum 2) are not included in a LPA's calculation of federal funds expended by the LPA for Single Audit purposes..
7. **Federal Registration:** LPA's are required to register with the System for Award Management or SAM, which is a web-enabled government-wide application that collects, validates, stores, and disseminates business information about the federal government's trading partners in support of the contract award and the electronic payment processes. To register or renew, please use the following website: <https://www.sam.gov/SAM/>

ADDENDA

Additional information and/or stipulations are hereby attached and identified below as being a part of this agreement.

<input checked="" type="checkbox"/>	1.	Location Map
<input checked="" type="checkbox"/>	2.	Division of Cost
<input checked="" type="checkbox"/>	3.	Resolution*
<input checked="" type="checkbox"/>	4.	State Construction Addendum for BLR 05310C
<input checked="" type="checkbox"/>	5.	Resolution Establishing a Class II or Prohibited Truck Route

*Appropriation and signature authority resolution must be in effect on, or prior to, the execution date of the agreement.

The LPA further agrees as a condition of payment, that it accepts and will comply with the applicable provisions set forth in this agreement and all Addenda indicated above.

APPROVED

Local Public Agency

Name of Official (Print or Type Name)

--

Title of Official

--

Signature

Date

--	--

The above signature certifies the agency's TIN number is

366006618 conducting business as a Governmental Entity.

DUNS Number 617892914

UEI

APPROVED

State of Illinois
Department of Transportation

Omer Osman, P.E., Secretary of Transportation

Date

--	--

By:

George A. Tapas, P.E., S.E., Engineer of Local Roads & Streets

Date

--	--

Stephen M. Travia, P.E., Director of Highways PI/Chief Engineer

Date

--	--

Yongsu Kim, Chief Counsel

Date

--	--

Vicki Wilson, Chief Fiscal Officer

Date

--	--

NOTE: A resolution authorizing the local official (or their delegate) to execute this agreement and appropriation of local funds is required to be attached as an addendum. The resolution must be approved prior to, or concurrently with, the execution of this agreement. If BLR 09110 or BLR 09120 are used to appropriate local matching funds, attach these forms to the signature authorization resolution.

☐ Please check this box to open a fillable Resolution Form within this Addenda.

LEE COUNTY WYOMING TOWNSHIP

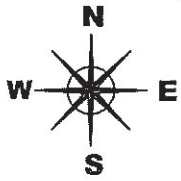

PALMYRA	DIXON	NACHUSA	FRANKLIN GROVE	ASHTON	REYNOLDS	ALTO
NELSON	SOUTH DIXON			BRADFORD		
HARMON	MARION	AMBOY	LEE CENTER		VIOLA	WILLOW CREEK
HAMILTON	EAST GROVE	MAY	SUBLETTE		BROOKLYN	WYOMING
						22

LEGEND

TWP ROAD ———
COUNTY ROAD ———
OTHER ROAD ———
COUNTY LINE ———

TWP BR/CULVERT ———
COUNTY BR/CULVERT ———
OTHER BR/CULVERT ———
TWP LINE ———

RAIL ROAD ———
STREAM ———
SECTION #
SECTION LINE

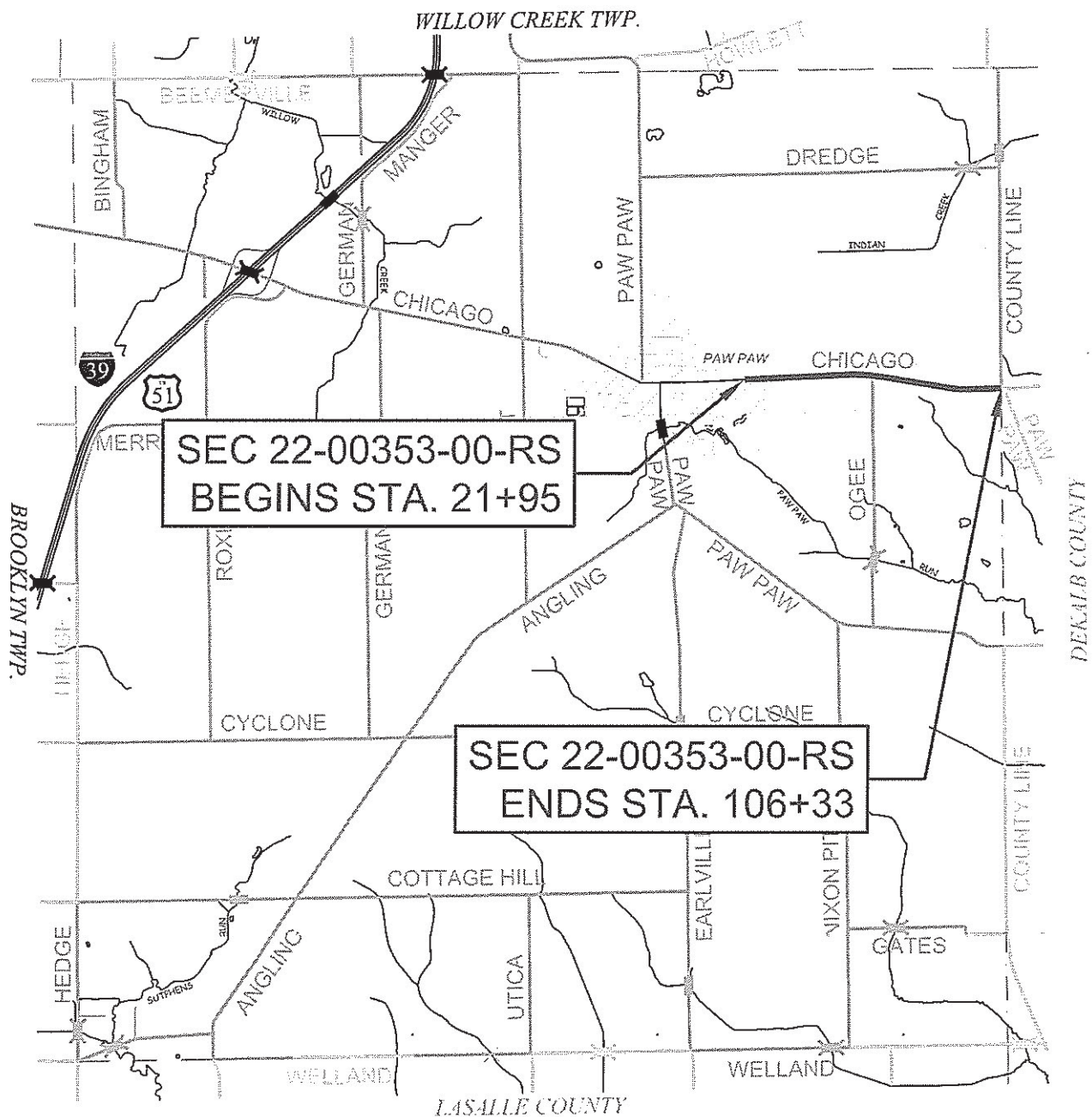

ADDENDA NUMBER 2

Local Public Agency	County	Section Number	State Job Number	Project Number
Lee County	Lee	22-00353-00-RS	C-92-047-24	

DIVISION OF COST

Type of Work	Federal Funds			State Funds			Local Public Agency			Totals
	Fund Type	Amount	%	Fund Type	Amount	%	Fund Type	Amount	%	
Participating Construction				TARP	\$145,800.00	*	Local	\$417,629.50	BAL	\$563,429.50
Total				Total	\$145,800.00		Total	\$417,629.50		\$563,429.50

If funding is not a percentage of the total place an asterisk (*) in the space provided for the percentage and explain below:

* 100% TARP FUNDS NTE \$145,800.00

NOTE: The costs shown in the Division of Cost table are approximate and subject to change. The final LPA share is dependent on the final Federal and State participation. The actual costs will be used in the final division of cost for billing and reimbursement.

Instructions for BLR 05310C Page 1 of 4

NOTE: Form instructions should not be included when the form is submitted.

This form shall be used when a local public agency (LPA) project involves Federal-Aid, with or without state funds and this standard form is sufficient to describe all details of the agreement. For more information refer to the Bureau of Local Roads and Streets (BLRS) Manual, Chapter 5. For signature requirements refer to Chapter 2, Section 3.05(b) of the BLRS manual. When filling out this form electronically, once a field is initially completed, fields requiring the same information will be auto-populated.

Local Public Agency

Name of LPA	Insert the name of the LPA.
County	Insert the name of the county in which the LPA is located.
Section Number	Insert the section number applied to this project.
Fund Type	Insert the funding type(s) being used for this project (e.g. STU, STR, ITEP, etc.).
ITEP, SRTS, HSIP, Number	Insert the ITEP, SRTS, HSIP number assigned to this project.
MPO Name	From the drop-down choose the MPO in which the project is located. If the project is not located within an MPO, select N/A. Types to choose from are: Bi-State Bi-State Regional Commission CMAP Chicago Metropolitan Planning Organization CUUATS Champaign/Urbana Urban Area Transportation Study DATS Danville Area Transportation Study DMATS Dubuque DSATS DeKalb/Sycamore Area Transportation Study DUATS Decatur Urbanized Area Transportation Study EWGCG East-West Gateway Council of Governments KATS Kankakee Area Transportation Study MCRPC McLean County Regional Planning Commission PPUATS Peoria/Pekin Urban Area Transportation Study RPC Region 1 Planning Council SATS Springfield Area Transportation Study SEMPO South East Metropolitan Planning Organization SIMPO Southern Illinois Metropolitan Planning Organization SLATS State Line Area Transportation Study
MPO Tip Number	Insert MPO Tip Number assigned to this project, this is required for all projects located within the MPO planning boundaries if applicable. If not, insert "N/A"
Construction	
Job Number	Insert the job number assigned for the construction portion, the number will begin with a "C"
Project Number	Insert the project number assigned to the construction portion of this project.
State-Let Construction	Check this box if the construction portion of this project will be on a state held letting.
Locally Let Construction	Check this box if the construction portion of this project will be on a locally held letting.
Construction Engineering	Check this box if the construction portion of this project will involve construction engineering.
Utilities	Check this box if the construction portion of this project will involve utility work.
Railroad Work	Check this box if the construction portion of this project will involve railroad work.
Location	Use the add location button to add additional locations if needed for up to a total of five locations. If there are more than five locations, use various.
Local Street/Road Name	Insert the local street/road name.
Key Route	Insert the key route of the street/road listed above.
Length	Insert the length in miles as it pertains to the location listed above. For a structure insert 0.01.
Station	
From	Insert the beginning station of the project as it pertains to the key route for this location for this project
To	Insert the ending station of the project as it pertains to the key route for this location for this project.
Location Termini	Insert the beginning and ending termini as it pertains to this location for this project.
Existing Structure Number(s)	Insert the existing structure number(s) for this project.
Add Location	Use this button to add additional locations. A total of four additional locations can be added. If there are more than 5 locations, do not add each location. Instead insert "Various" in the first location field.
Project Description	Insert a description of the work to be accomplished by this project.

Instructions for BLR 05310C Page 2 of 4

Method of Financing	This area is for state-let contract only. Check one.
Method A	If this box is checked, insert the dollar amount equal to 80% of the LPA's total obligation.
Method B	If this box is checked, insert the number of monthly payments needed to repay 80% of the LPA's estimated obligation.
Method C	If this box is checked, insert the dollar amount of the LPA's share of the construction costs for this project.

For State-Let Construction Projects

Addenda

Within the addenda table, check the box as applicable. Insert the item number of the addenda and a description of the item.

1. Location Map — Attach a location map to this agreement showing all locations being improved by this project.
2. Division of Cost — Insert the division of cost age (see separate instructions for completing this document).
3. LPA Resolution — The LPA must pass an appropriation resolution covering the local share of the project and must grant signature authority to the signee. Attach the resolution as Addendum 3. If BLR 09110 or BLR 09120 are used to appropriate local fund, attach these forms to the signature authorization resolution.
4. IDOT Fiscal Approval Signature Page.

Approved

Local Public Agency	The appropriate LPA official shall insert their name, sign, and date. Insert the LPA's TIN number, DUNS Number, and the UEI (note the UEI will be replacing the DUNS Number https://sam.gov/content/duns-uei).
Illinois Dept. of Transportation	The appropriate IDOT official shall sign and date here.

Division of Cost Table

When the LPA desires to use one or more lump-sum amounts before the federal percentage is calculated, specify the order in which it should be used and the "not to exceed" amount. The following provides an example of the wording that may be used:

Lump-sum \$60,000 TARP funds not to exceed 50% of final cost of project credited to the project to be utilized first.
Lump-sum to be utilized second not to exceed \$20,000 EDP funds.
Lump-sum to be utilized third not to exceed \$40,000 SMA funds.

These specified amounts will be used in sequence, with the federal and local percentages calculated after they are deducted.

When the LPA desires to use a percent "not to exceed" commitment, the federal and state funds will be used concurrently at the specified percentages up to the "not to exceed" amount.

Example: Maximum STR participation 80% not to exceed \$100,000.
Lump-sum SMA not to exceed \$20,000 to be used as a match to the federal funds.

Be advised that the "not to exceed" amount specified under a percentage commitment will be tied up and unavailable for programming until the project is closed out and a documentation review has been completed by IDOT or FHWA, if required.

Division of Cost Table

Use a separate line for each type of work as it relates to the fund type for federal, state and/or LPA funds.

Type of Work	Choose the type of work from the drop-down list. Types to choose from are: Participating Construction, Non-Participating Construction, Construction Engineering, Railroads, Utilities, and Materials.
Federal Funds	If federal funds are being used on this project complete the following for federal funds.
Fund Type	Choose the type of federal fund type from the drop-down.
Amount	Insert the amount of federal funds for the type of listed under fund type.
%	Insert the percentage of federal funds for this type.
State Funds	If state funds are being used on this project complete with following for state funds.
Fund Type	Choose the type of state fund type from the drop-down.
Amount	Insert the amount of state funds for the type of listed under fund type.
%	Insert the percentage of state funds for this type.
Local Public Agency Funds	
Fund Type	Choose the type of LPA funds from the drop-down.
Amount	Insert the amount of LPA funds for the type of listed under fund type.
%	Insert the percentage of LPA funds for this type.
Explanation	Insert any necessary additional information as to how the funding is being applied for this project.

A minimum of three (3) originals executed by the LPA must be submitted to the District through its Regional Engineer's Office. Distribution will be as follows:

District file
Bureau of local Roads Central Office (2)

Instructions for BLR 05310C Page 3 of 4

Printing Instructions

For the document to print properly, please make sure "Orientation" is set to "Auto" (see image below) within the print dialog window. If this setting is not chosen, then some pages may be cut off during the printing process.

Orientation:



☒ Auto

☐ Portrait

☐ Landscape

Sample Resolution

RESOLUTION No: _____

A Resolution for:

Section No: _____

Job No.: _____

Project No.: _____

WHEREAS, the [city, village, town, county] of _____ is proposing to
_____.

WHEREAS, the above stated improvement will necessitate the use of funding provided through the Illinois Department of Transportation (IDOT); and signee

WHEREAS, the use of these funds requires a joint funding agreement (AGREEMENT) with IDOT; and

WHEREAS, the improvement requires matching funds; and

NOW, THEREFORE, be it resolved by the {Board}:

Section 1: The {Board} hereby appropriates \$ _____, _____ or as much as may be needed to match the required funding to complete the proposed improvement from {Local fund source} and furthermore agree to pass a supplemental resolution if necessary to appropriate additional funds for completion of the project.

Section 2: The {Local Official or delegate} is hereby authorized to execute an AGREEMENT with IDOT for the above-mentioned project.

Section 3: This resolution will become Attachment 3 of the AGREEMENT.

Section 4: The _____ Clerk of _____ is directed to transmit 3 (three) copies of the AGREEMENT and Resolution to IDOT District _____ Bureau of Local Roads and Streets.

I, _____, _____ Clerk in and for _____, Illinois, and keeper of the records and files thereof, as provided by statute, do hereby certify the forgoing to be a true, perfect and complete copy of the resolution approved by the _____ at its meeting on the _____ day of _____, 20__.

IN TESTIMONY WHEREOF; I have unto set my hand and seal, at my office, this _____ day of _____, 20__.

(seal)



Is this project a bondable capital improvement?

☐ Yes ☐ No

Resolution Type

Resolution Number

Section Number

BE IT RESOLVED, by the _____ of the _____

Governing Body Type

Local Public Agency Type

of _____ Illinois that the following described street(s)/road(s)/structure be improved under

Name of Local Public Agency

the Illinois Highway Code. Work shall be done by _____.

Contract or Day Labor

For Roadway/Street Improvements:

Name of Street(s)/Road(s)	Length (miles)	Route	From	To

For Structures:

Name of Street(s)/Road(s)	Existing Structure No.	Route	Location	Feature Crossed

BE IT FURTHER RESOLVED,

1. That the proposed improvement shall consist of

2. That there is hereby appropriated the sum of _____

Dollars (_____) for the improvement of

said section from the Local Public Agency's allotment of Motor Fuel Tax funds.

BE IT FURTHER RESOLVED, that the Clerk is hereby directed to transmit four (4) certified originals of this resolution to the district office of the Department of Transportation.

I, _____ Clerk in and for said _____

Name of Clerk

Local Public Agency Type

Local Public Agency Type

of _____ in the State aforesaid, and keeper of the records and files thereof, as provided by

Name of Local Public Agency

statute, do hereby certify the foregoing to be a true, perfect and complete original of a resolution adopted by

_____ of _____ at a meeting held on _____.

Governing Body Type

Name of Local Public Agency

Date

IN TESTIMONY WHEREOF, I have hereunto set my hand and seal this _____ day of _____.

Day

Month, Year

(SEAL, if required by the LPA)

Clerk Signature & Date

Approved

Regional Engineer Signature & Date
Department of Transportation

Instructions for BLR 09110 - Page 1 of 2

NOTE: Form instructions should not be included when the form is submitted.

This form shall be used when a Local Public Agency (LPA) wants to construct an improvement using Motor Fuel Tax(MFT) funds. Refer to Chapter 9 of the Bureau of Local Roads and Streets Manual (BLRS Manual) for more detailed information. For signature requirements refer to Chapter 2, Section 3.05(b) of the BLRS Manual.

When filling out this form electronically, once a field is initially completed, fields requiring the same information will be auto-populated.

Is this project a bondable capital improvement?

Check Yes if the project was a bondable capital improvement, check no if it is not. An example of a bondable capital project may include, but is not limited to: project development, design, land acquisition, demolition when done in preparation for additional bondable construction, construction engineering, reconstruction of a roadway, designed overlay extension or new construction of roads, bridges, ramps, overpasses and underpasses, bridge replacement and/or major bridge rehabilitation. Permanent ADA sidewalk/ramp improvements and seeding/sodding are eligible expenditures if part of a larger capital bondable project. A bondable capital improvement project does not mean the LPA was required to sell bonds to fund the project, however the project did meet the criteria to be bondable.

Resolution Number

Enter the resolution number as assigned by the LPA, if applicable.

Resolution Type

From the drop down box choose the type of resolution:

- Original would be used when passing a resolution for the first time for this project.
- Supplemental would be used when passing a resolution increasing appropriation above previously passed resolutions.
- Amended would be used when a previously passed resolution is being amended.

Section Number

Insert the section number of the improvement the resolution covers.

Governing Body Type

From the drop down box choose the type of administrative body. Choose Board for County; Council for a City or Town; President and Board of Trustees for a Village or Town.

LPA Type

From the drop down box choose the LPA body type. Types to choose from are: County, City, Town or Village.

Name of LPA

Insert the name of the LPA.

Contract or Day Labor

From the drop down choose either Contract or Day Labor.

Roadway/Street Improvements:

Name Street/Road

Insert the name of the Street/Road to be improved. For additional locations use the Add button.

Length

Insert the length of this segment of roadway being improved in miles.

Route

Insert the Route Number of the road/street to be improved if applicable.

From

Insert the beginning point of the improvement as it relates to the Street/Road listed to the left.

To

Insert the ending point of the improvement as it relates to the Street/Road listed to the left.

Structures:

Name Street/Road

Insert the name of the Street/Road on which the structure is located. For additional locations use the Add button.

Existing Structure No.

Insert the existing structure number this resolution covers, if no current structure insert n/a.

Route

Insert the Route number on which the structure is located.

Location

Insert the location of the structure.

Feature Crossed

Insert the feature the structure crosses.

1

Insert a description of the major items of work of the proposed improvement.

2

Insert the dollar value of the resolution for the proposed improvement to be paid for with MFT funds in words followed by in the same amount in numerical format in the ().

Instructions for BLR 09110 - Page 2 of 2

Name of Clerk	Insert the name of the LPA clerk.
LPA Type	Insert the type of clerk based on the LPA type. Types to choose from are: County, City, Town or Village.
Name of LPA	Insert the name of the LPA.
Governing Body Type	Insert the type of administrative body. choose Board for County; Council for a City or Town; President and Board of Trustees for a Village or Town
Name of LPA	Insert the name of the LPA.
Date	Insert the date of the meeting.
Day	Insert the day Clerk is signing the document.
Month, Year	Insert the month and year of the Clerk's signature.
Seal	The Clerk shall seal the document here, if required. If a seal is required, electronic signatures should not be used.
Clerk Signature	Clerk shall sign here.
Approved	The Department of Transportation shall sign and date here once approved.

A minimum of three (3) certified signed originals must be submitted to the Regional Engineer's District office OR email PDF completed form with electronic signatures to your local District LRS office.

Following IDOT's approval, distribution will be as follows:

Local Public Agency Clerk
Engineer (Municipal, Consultant or County)
District

Addendum # 4

CHANGES IN AGREEMENT PROVISIONS
FORM BLR 05310C - STATE FUNDS ONLY

WHEREAS, it is necessary to revise certain portions of the Agreement.

BE IT MUTUALLY AGREED that the following shall be revised as follows:

Delete all references to the Federal Highway Administration (FHWA) and specific federal requirements.

METHOD OF FINANCING – (State-Let Contract Work Only)

Delete entire section.

THE STATE AGREES:

Delete Articles 1, 2, and 3.

Revise the first sentence in Article 4 to read: "For agreements with State funds in construction, construction engineering utility work, and/or railroad work:"

BE IT MUTUALLY AGREED that all remaining provisions of the original agreement not altered by this addendum shall remain in full force and effect.



Resolution Establishing a Class II
or Prohibited Truck Route

Resolution Number

--

WHEREAS, the State of Illinois by its General Assembly has enacted the Illinois Vehicle Code, and

WHEREAS, 625 ILCS 5/1-126.1 provides that local authorities may designate Class II or Prohibited Truck Route highways within their jurisdiction, and its accordance with 625 ILCS 5/15-111(f), weight limitations shall be designated by appropriate signs placed on such highways; and

WHEREAS, _____ of _____ is desirous of designating
Local Public Agency Type Local Public Agency
truck routes under their jurisdiction as follows:

NOW THEREFORE, BE IT RESOLVED, that the portion of roadways as listed below will be designated as shown.

Route/Street Name(s)	Beginning Termini	Ending Termini	Length	Designation
-				

Add Row

BE IT FURTHER RESOLVED, that _____ of _____
Local Public Agency Type Local Public Agency

in accordance with 625 ILCS 5/15-116 which requires local public agencies to provide the Department of Transportation with reference contact names and telephone numbers provides contact information as follows:

Name	Title	Phone Number

BE IT FURTHER RESOLVED, that the Clerk is hereby directed to transmit three (3) certified originals of this resolution to the district office of the Department of Transportation along with a location map indicating the roadways being classified.

I, _____ Clerk in and for said _____
Name of Clerk Local Public Agency Type Local Public Agency Type
of _____ in the State aforesaid, and keeper of the records and files thereof,
Local Public Agency

as provided by statute, do hereby certify the foregoing to be a true, perfect and complete original of a resolution adopted by

_____ of _____ at a meeting held on _____
Local Public Agency Type Local Public Agency Date

IN TESTIMONY WHEREOF, I have hereunto set my hand and seal this _____ day of _____ .
Day Month/Year

(SEAL, if required by the LPA)

Signature & Date

--

Instructions for BLR 03210

NOTE: Form instructions should not be included when the form is submitted.

This form shall be used when a Local Public Agency (LPA) designates a roadway as a Class II or Prohibited Truck Route. For more information see Chapter 3 of the Bureau of Local Roads and Streets Manual (BLRS Manual).

For signature requirements, refer to Chapter 2, Section 3.05(b) of the BLRS Manual. For information concerning current designated truck routes: <http://www.gettingaroundillinois.com/gai.htm?mt=dr>

For forms completed electronically once a field is completed, fields requiring the same information will be automatically completed.

Resolution Number	The LPA can insert their resolution number assigned to this resolution if applicable.
Local Public Agency Type	Insert the type of LPA. Choose from: City, County, Town, or Village.
Local Public Agency	Insert the name of the LPA.
For each roadway insert the following:	
Route/Street Name(s)	Insert the name of the roadway/street begin designated as a Class II or Prohibited Truck Route
Beginning Termini	Insert the beginning termini of the roadway being designated.
Ending Termini	Insert the ending termini of the roadway being designated.
Class Type	Insert the type of designation, a Class II or Prohibited Truck Route.
Enter additional locations by clicking the "Add" button.	
Local Public Agency Type	Insert the type of LPA type: Choose from City, County, Town, or Village.
Local Public Agency	Insert the name of the LPA.
Name	Insert the name of the contact. As changes occur, this information shall be updated and the Department of Transportation notified via letter
Title	Insert the title of the contact listed to the left.
Phone Number	Insert the phone number for the contact listed to the left.
Name of Clerk	Insert the name of the LPA clerk.
Clerk Type	Insert the type of clerk based on the LPA type. Types to choose from are: County, City, Town, or Village.
Governing Body Type	Insert the type of administrative body. Choose Board for County, Council for a City or Town, choose President and Board of Trustees for a Village.
Name of LPA	Insert the name of the LPA.
Date	Insert the date of the meeting
Day	Insert the day the Clerk is signing the document.
Month/Year	Insert the month and year of the clerk's signature.
Seal	The Clerk shall seal the document here, if required. If a seal is required, electronic signatures should not be used.
Clerk	Clerk shall sign here.

A minimum of three (3) certified signed originals must be submitted to the Regional Engineer's District office OR email PDF completed form with electronic signatures to your local District LRS office.

Local Public Agency Clerk

Engineer (Municipal, Consultant or County)

District

Upon processing of the form by the District, the District is also responsible to email a PDF of the form to the following:

DOT.ROADINFO@illinois.gov

Bureau of Operations

dot.localpolicy@illinois.gov

Bureau of Local Roads, Central Office

DOT.IHIS@illinois.gov

Roadway Inventory, Central Office